

# LOMANCO

# EVA COMBO VENT

## THE ORIGINAL SLANT BACK ROOF LOUVER with ADAPTER FOR 3" OR 4" DUCT



Roof Vents available in 5 colors

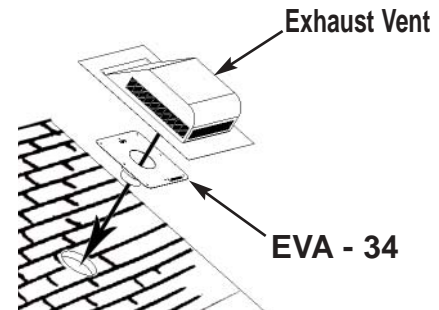
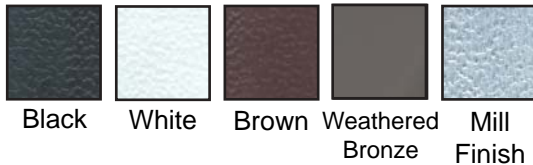

## Another Lomanco Innovation!

### Roof Louver features:

- Fits all pitched roofs.
- Weather-tight seamed collar.
- Prevents roof discoloration.
- Embossed painted finish for added strength, extended paint life, durability, and blending appearance with shingles.
- Bird-proof.
- Large nailing flange.
- Available in aluminum or galvanized steel construction
- Available in black, brown, weathered bronze, and white baked enamel finishes, as well as mill finish.
- Dade County Approved #01-0614.05

### EVA - 34 features:

- Exhaust vent adapter fits 3" or 4" flexible duct.
- Designed for use with bathroom exhaust fans
- Exhausts household moisture.
- Tested for all climates.
- Built in damper prevents backdraft.
- Works with any roof system.
- Ideal for new construction.
- Solution for existing homes.
- 10" nailing flange.



**Lomanco, Inc.**  
 P.O. Box 519 • 2101 West Main  
 Jacksonville, AR 72076  
**800-643-5596**  
 info@lomanco.com  
 www.lomanco.com

LO407

MODEL # EVACV EVA Combo Vent Specifications				
Vent Overall Dimension	Adapter Overall Dimension	Adapter Size	Weight per Carton	Packaging
12 <sup>3</sup> / <sub>16</sub> " x 17 <sup>3</sup> / <sub>4</sub> " x 4"	10" x 10" x 3 <sup>1</sup> / <sub>4</sub> "	Accommodates 3" & 4" Duct	Alum. 13.3 lbs. Galv. 20.3 lbs.	6 single packed units per master carton